

Logging into the Claimant Portal with ID.me

WHY DO I NEED TO LOGIN USING ID.ME?

All unemployment insurance claimants must sign in to ID.me before accessing Claimant Portal.

Using ID.me to verify your identity helps us confirm you are the person filing for unemployment insurance and not someone pretending to be you.

You will need to sign into ID.me any time you access the Claimant Portal. Each time you log in, you will type in your email address and password. Then, you will be prompted to complete the process by entering a 6-digit code from your cell phone to ID.me.

Note: *If you do not have a cell phone,* visit an Idaho Department of Labor office to sign in and complete the process. To find the nearest location, visit labor.idaho.gov/officedirectory.

We recommend you schedule an appointment before visiting a local office. Unemployment Insurance Navigators are available at some locations to guide you through the unemployment insurance system. Contact your nearest office at the phone number listed in the directory. You can also speak to a Claim Specialist at 208-332-8942 for help with scheduling an appointment.

Once you complete the identity verification process, you will be able to access the Claimant Portal as normal.

USE THE FOLLOWING STEPS TO LOG IN:

1. Go to the Claimant Portal at labor.idaho.gov/claimantportal to see this screen.

The screenshot shows the Claimant Portal login page. At the top, there is a navigation bar with the Idaho Department of Labor logo on the left and links for 'Español', 'User Guides', 'Contact Us', 'Idaho.gov', and 'Login' on the right. A 'HELP' button is also present. The main heading is 'Claimant Portal' with the subtitle 'Internet Unemployment System'. Below this, there is a 'Welcome to Claimant Portal' section. The text explains that the portal is a secure, self-service system for managing unemployment benefits. A list of services includes applying for benefits, filing certification applications, managing profiles, accessing claim details, and viewing benefit payments. A 'Login' section features a prominent green button that says 'Sign in with ID.me'. Below the button, it states that ID.me is a trusted technology partner for identity verification. At the bottom, there are links to 'Quick Start Guide' and 'ID.me Instructions', a 'Please Note' section about credit card information, and an 'Important' section about logging out in public settings.

2. Click on the **Sign in with ID.me** button.
3. The screen below will appear. Type in your email address and password, then click the **Sign in** button.

If you do NOT have an ID.me account, click on Create an ID.me account. Then follow the [verifying for Idaho state benefits instructions](#) at [help.id.me](#).

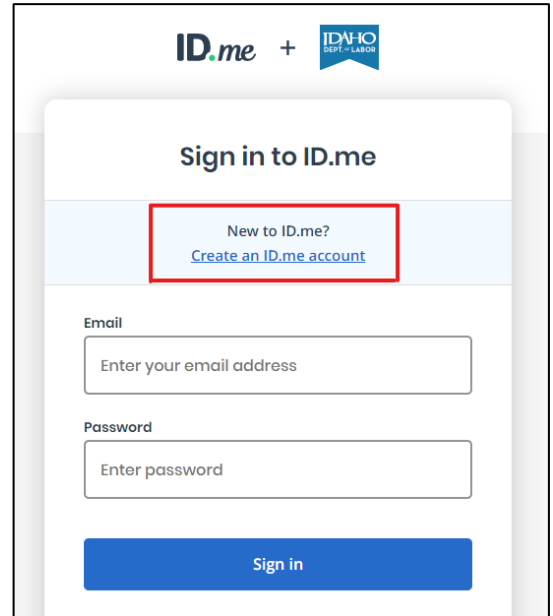

4. Choose how you want to receive your sign in code. Make your selection, then click **Continue**.

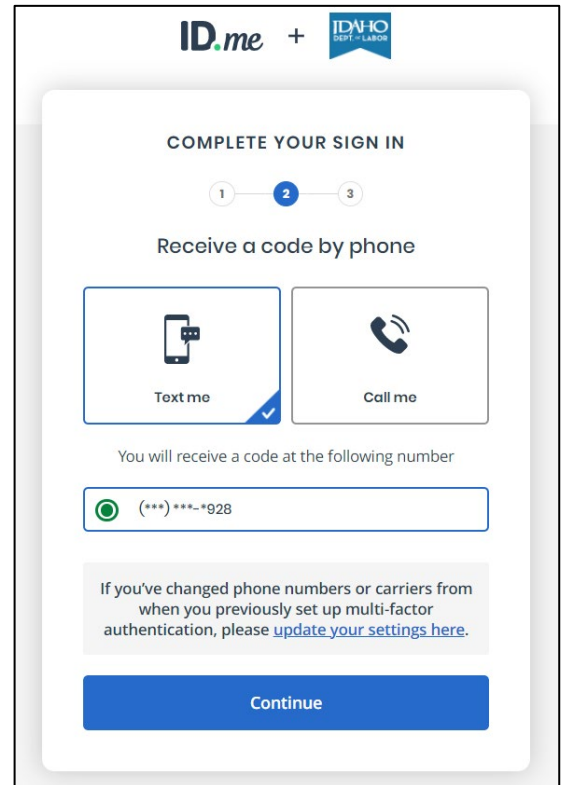

- After clicking Continue, you will see the following screen. You will receive your code either through text or phone call based on the option you chose. Enter the code and click **Continue**.

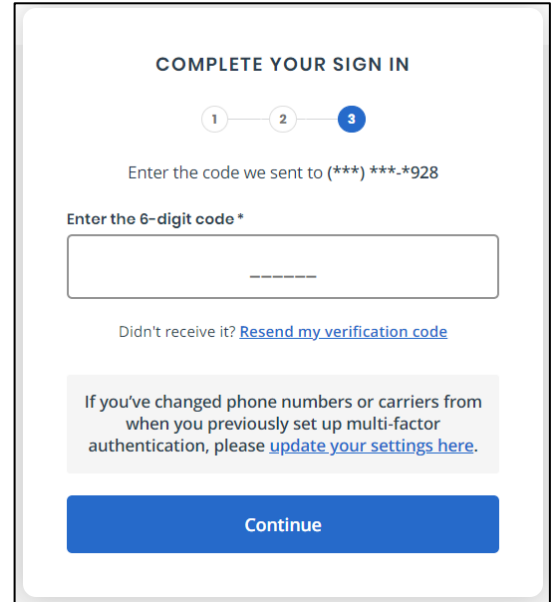

- You will see the screen below. Read the statement and click **Yes**. You will then be returned to the Claimant Portal.

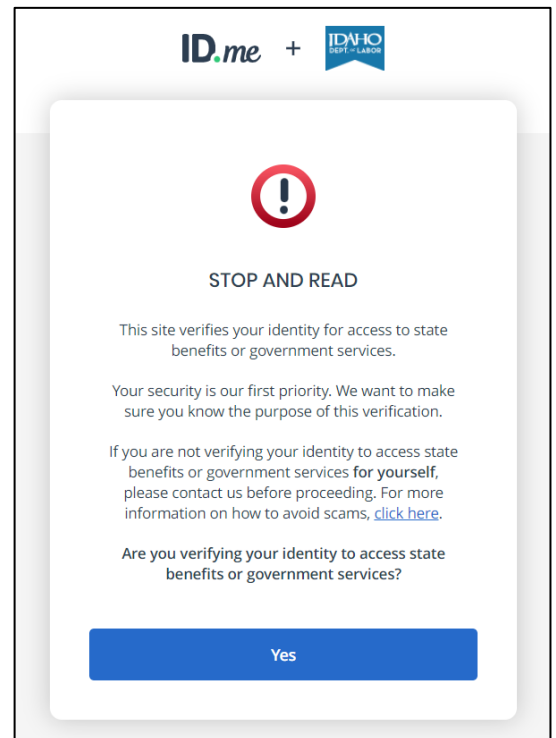

- You are now logged into the Claimant Portal and can access all your account information as normal.